

The 1574 series features a flat face design and a 90° double inside chamfer for surfaces with good bondability. The 90° double inside chamfer provides excellent 2nd bond tailing and a taller, more compact ball bond.

The 1574N may be specified for a 120° inside chamfer for surfaces with poor 1st bond bondability.

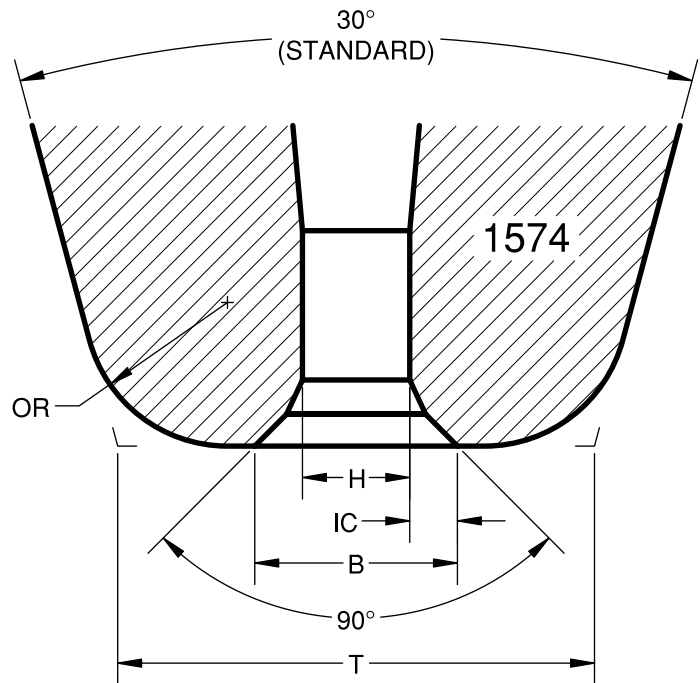
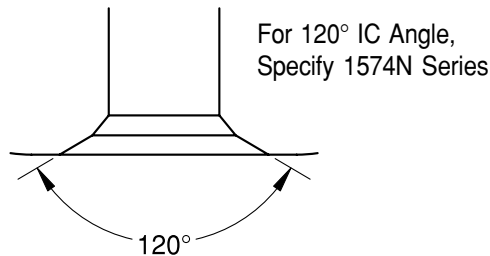

Specify: Series - Dash Number - Length+Finish - Options
Example: 1574-18-437GM-20D

Note: For Tungsten Carbide material, specify 1174 & 1174N series (1/16 in. diameter only).
 For 1/8 in. diameter ceramic, specify 1274 & 1274N series.

SERIES & DASH NO.	H* in./µm ±.0001/2.5	IC in./µm (ref)	B** in./µm ±.0002/5	OR*** in./µm ±.0003/8	T (30° CONE) in./µm ±.0003/8	T (20° CONE) in./µm ±.0003/8	SUGGESTED WIRE DIAMETER in./µm
1574-10	.0010/25	.0002/5	.0014/36	.0025/64	.0065/165	.0068/174	.0005/13 to .0008/20
1574-12	.0012/30	.0002/5	.0016/41	.0025/64	.0065/165	.0068/174	.0007/18 to .0009/23
1574-13	.0013/33	.0003/8	.0019/48	.0025/64	.0065/165	.0068/174	.0008/20 to .0010/25
1574-15S	.0015/38	.0003/8	.0021/53	.0035/89	.0080/203	.0085/216	.0009/23 to .0011/28
1574-17	.0017/43	.0007/18	.0031/79	.0024/61	.0080/203	.0083/211	.0010/25 to .0013/33
1574-17S	.0017/43	.0002/5	.0021/53	.0035/89	.0080/203	.0085/216	
1574-18	.0018/46	.0008/20	.0034/86	.0024/61	.0080/203	.0083/211	
1574-18M	.0018/46	.00055/14	.0029/74	.0024/61	.0080/203	.0083/211	
1574-18S	.0018/46	.0002/5	.0022/56	.0035/89	.0080/203	.0085/216	.0013/33 to .0015/38
1574-20	.0020/51	.0007/18	.0034/86	.0024/61	.0080/203	.0083/211	
1574-20M	.0020/51	.00045/11	.0029/74	.0024/61	.0080/203	.0083/211	
1574-22	.0022/56	.0006/15	.0034/86	.0024/61	.0080/203	.0083/211	
1574-22M	.0022/56	.00035/9	.0029/74	.0024/61	.0080/203	.0083/211	.0015/38 to .0020/51
1574-25	.0025/64	.0005/13	.0035/89	.0024/61	.0080/203	.0083/211	
1574-30	.0030/76	.0010/25	.0050/127	.0055/140	.0165/419	.0172/437	.0020/51
1574-35	.0035/89	.0008/20	.0051/130	.0065/165	.0165/419	.0174/442	.0020/51 to .0025/64
1574-35S	.0035/89	.0008/20	.0051/130	.0055/140	.0165/419	.0172/437	
1574-40	.0040/102	.0010/25	.0060/152	.0065/165	.0165/419	.0174/442	.0030/76
1574-50	.0050/127	.0012/30	.0074/188	.0070/178	.0190/483	.0200/508	.0040/102

* For hole sizes less than 0.0011 and hole sizes 0.0025 through 0.0049, the tolerance is +.0002/-0.0001. For hole sizes greater than 0.0049, the tolerance is +.0003/-0.0002.

** For B dimensions greater than 0.0040, the tolerance is +.0003/-0.0002.

***OR tolerance ±.0003 for OR less than or equal to .0030; for OR greater than .0030, tolerance is ±10%.

Tighter tolerance available at additional charges. *Dimensions in inches unless otherwise specified*