

The 1548 series capillary is designed for applications with good bondability. Typically specified with a polished finish, the 1548 will provide long tool life on surfaces with good metallization. The 1548 series features a flat face, large outside radius, and a 90° double inside chamfer design. The “GM” Gaiser matte finish may be specified for enhanced 2nd bond performance on surfaces with difficult bondability.

The 1548N may be specified for a 120° inside chamfer for applications with poor 1st bond bondability.

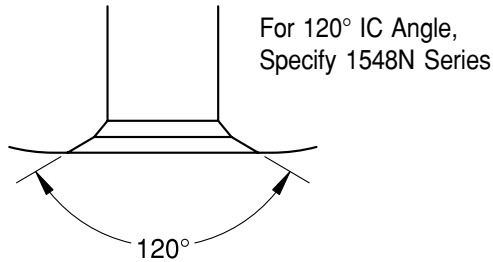
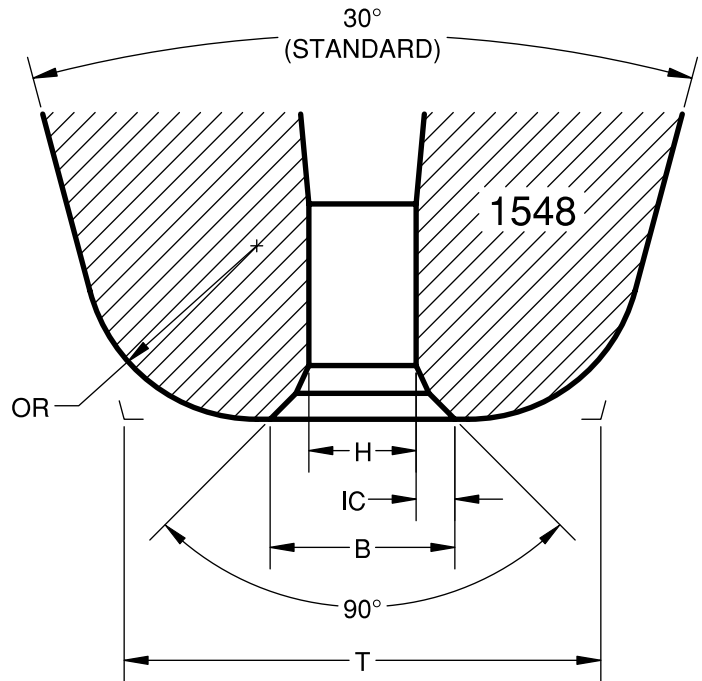

**Specify:** Series - Dash Number - Length+Finish - Options

**Example:** 1548-18-437P

Note: For Tungsten Carbide material, specify 1148 & 1148N series (1/16 in. diameter only).

For 1/8 in. diameter ceramic, specify 1248 & 1248N series.

SERIES & DASH NO.	H* in./µm ±.0001/2.5	IC in./µm (ref)	B** in./µm ±.0002/5	OR*** in./µm ±.0003/8	T (30° CONE) in./µm ±.0003/8	T (20° CONE) in./µm ±.0003/8	SUGGESTED WIRE DIAMETER in./µm
<b>1548-10</b>	.0010/25	.0004/10	.0018/46	.0018/46	.0050/127	.0052/132	.0005/13 to .0008/20
<b>1548-12</b>	.0012/30	.00035/9	.0019/48	.0018/46	.0050/127	.0052/132	.0007/18 to .0009/23
<b>1548-13</b>	.0013/33	.0004/10	.0021/53	.0021/53	.0060/152	.0063/160	.0008/20 to .0010/25
<b>1548-15</b>	.0015/38	.0005/13	.0025/64	.0025/64	.0070/178	.0073/185	.0009/23 to .0011/28
<b>1548-17</b>	.0017/43	.0006/15	.0029/74	.0029/74	.0080/203	.0084/213	.0010/25 to .0013/33
<b>1548-18</b>	.0018/46	.00065/17	.0031/79	.0029/74	.0080/203	.0084/213	
<b>1548-20</b>	.0020/51	.0007/18	.0034/86	.0032/81	.0090/229	.0094/239	.0013/33 to .0015/38
<b>1548-22</b>	.0022/56	.0007/18	.0036/91	.0032/81	.0090/229	.0094/239	
<b>1548-30</b>	.0030/76	.0009/23	.0048/122	.0048/122	.0140/356	.0147/373	.0020/51
<b>1548-35</b>	.0035/89	.0009/23	.0053/135	.0065/165	.0165/419	.0174/442	.0020/51 to .0025/64
<b>1548-40</b>	.0040/102	.00125/32	.0065/165	.0065/165	.0185/470	.0194/493	.0030/76

\* For hole sizes less than 0.0011 and hole sizes 0.0025 through 0.0049, the tolerance is +.0002/-0.0001. For hole sizes greater than 0.0049, the tolerance is +.0003/-0.0002.

\*\* For B dimensions greater than 0.0040, the tolerance is +.0003/-0.0002.

\*\*\*OR tolerance ±.0003 for OR less than or equal to .0030; for OR greater than .0030, tolerance is ±10%.

Tighter tolerance available at additional charges. *Dimensions in inches unless otherwise specified*