

Material:

Tungsten Carbide Standard

-TiC = Titanium Carbide

-BKCR = Cermet Tip

-DT = Diamond Tip

Specify: Series - Face/Outside Radius/Cross Groove Spec. - Length - Options

Example:

1183-06010B-750-TiC-SDF-20D

1183-02008D-437

Options:

-SDF = Tool makes a "+" pattern

-SDFA = Tool makes a "x" pattern

-20D = 20° Cone Angle (30° standard)

Bottlenecks may be designed

Lengths:

-375 = 0.375 in./9.52mm

-437 = 0.437 in./11.1mm

-625 = 0.625 in./15.88mm

-750 = 0.750 in./19.05mm

-828 = 0.828 in./21.03mm

-1.0 = 1.000 in./25.4mm

Other = Specify

DASH NUMBER	FACE in./μm ±.0002/5	OR in./μm ±.0002/5	T 30° in./μm ±.0003/8	CGR in./μm ±.0001/3	CGD in./μm ±.0001/3
01705D	.0017/43	.0005/13	.0024/61	.0003/8	.0003/8
02008D	.0020/51	.0008/20	.0032/81	.0003/8	.0003/8
02010B	.0020/51	.0010/25	.0035/89	.0005/13	.0005/13
02205D	.0022/56	.0005/13	.0030/76	.0003/8	.0003/8
03010B	.0030/76	.0010/25	.0045/114	.0005/13	.0005/13
03510B	.0035/89	.0010/25	.0050/127	.0005/13	.0005/13
04010B	.0040/102	.0010/25	.0055/140	.0005/13	.0005/13
04510B	.0045/114	.0010/25	.0060/152	.0005/13	.0005/13
05010B	.0050/127	.0010/25	.0065/165	.0005/13	.0005/13
06010B	.0060/152	.0010/25	.0075/191	.0005/13	.0005/13
08010B	.0080/203	.0010/25	.0095/241	.0005/13	.0005/13
08010C	.0080/203	.0010/25	.0095/241	.0010/25	.0010/25
09020C	.0090/229	.0020/51	.0121/307	.0010/25	.0010/25
12020C	.0120/305	.0020/51	.0151/384	.0010/25	.0010/25

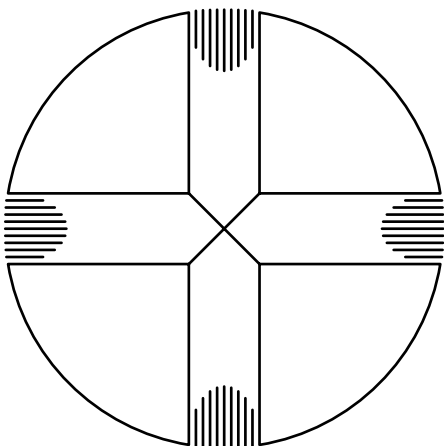
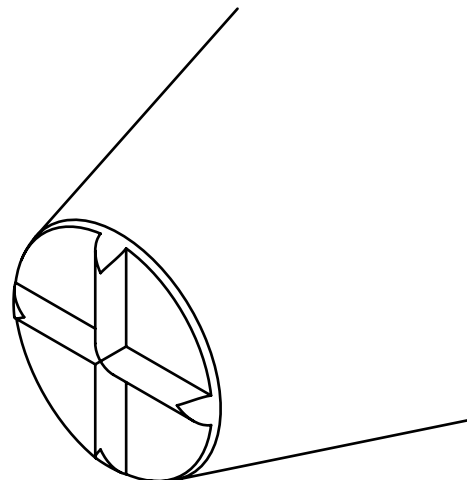
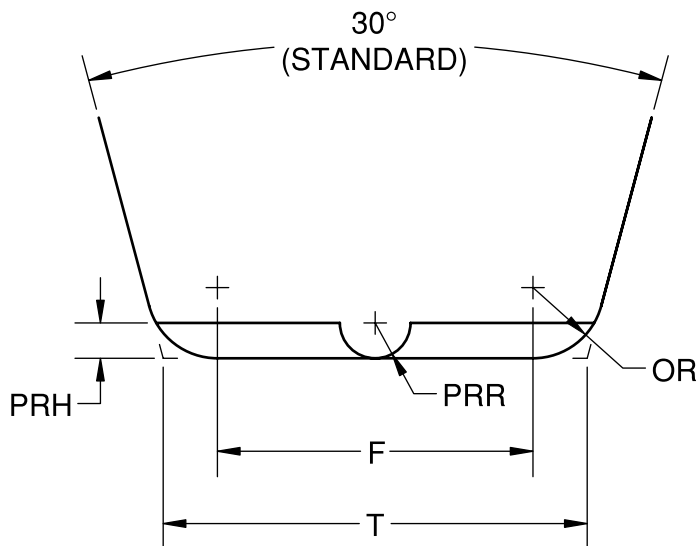

Material:

Tungsten Carbide Standard

-TiC = Titanium Carbide

-BKCR = Cermet Tip

-DT = Diamond Tip

Specify: Series - Face/Outside Radius/Protruding Radius Spec. - Length - Options

Example:

1184-06010B-750-TiC-SDF-20D

1184-02008D-437

Options:

-SDF = Tool makes a "+" pattern

-SDFA = Tool makes a "x" pattern

-20D = 20° Cone Angle (30° standard)

Bottlenecks may be designed

Lengths:

-375 = 0.375 in./9.52mm

-437 = 0.437 in./11.1mm

-625 = 0.625 in./15.88mm

-750 = 0.750 in./19.05mm

-828 = 0.828 in./21.03mm

-1.0 = 1.000 in./25.4mm

Other = Specify

DASH NUMBER	FACE in./ μ m \pm .0002/5	OR in./ μ m \pm .0002/5	T 30° in./ μ m \pm .0003/8	PRR in./ μ m \pm .0001/3	PRH in./ μ m \pm .0001/3
01705D	.0017/43	.0005/13	.0024/61	.0003/8	.0003/8
02008D	.0020/51	.0008/20	.0032/81	.0003/8	.0003/8
02205D	.0022/56	.0005/13	.0030/76	.0003/8	.0003/8
03008D	.0030/76	.0008/20	.0042/107	.0003/8	.0003/8
03510B	.0035/89	.0010/25	.0050/127	.0005/13	.0005/13
04510B	.0045/114	.0010/25	.0060/152	.0005/13	.0005/13
05010B	.0050/127	.0010/25	.0065/165	.0005/13	.0005/13
06010B	.0060/152	.0010/25	.0075/191	.0005/13	.0005/13
07010B	.0070/178	.0010/25	.0085/216	.0005/13	.0005/13
08010B	.0080/203	.0010/25	.0095/241	.0005/13	.0005/13
08010C	.0080/203	.0010/25	.0095/241	.0010/25	.0010/25
09020C	.0090/229	.0020/51	.0121/307	.0010/25	.0010/25
12020C	.0120/305	.0020/51	.0151/384	.0010/25	.0010/25

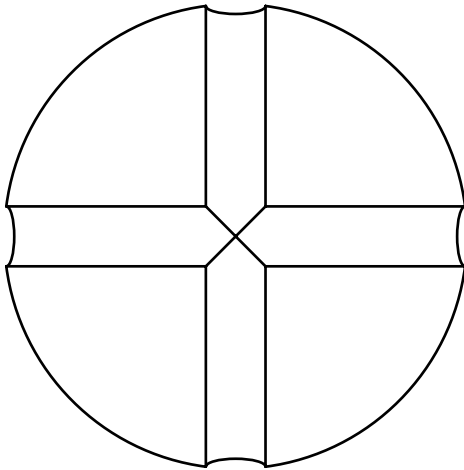
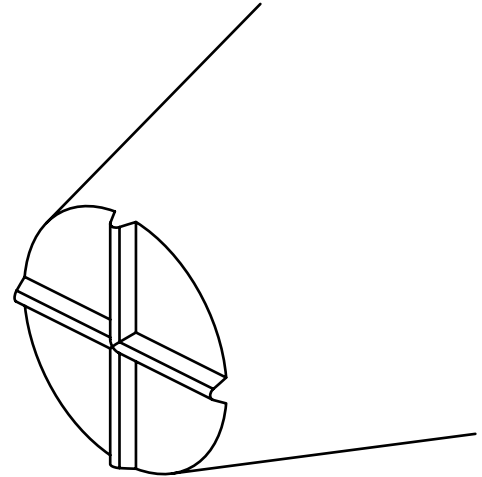
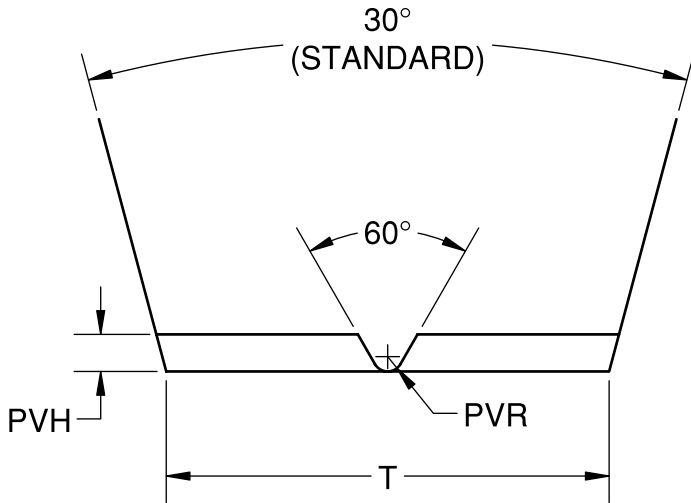

Material:

- Tungsten Carbide Standard
- TiC = Titanium Carbide
- BKCR = Cermet Tip
- DT = Diamond Tip

Specify: Series - Tip Dia./Protruding "V" Height & Radius- Length - Options

Example:

- 1186-060052-437-TiC-SDF
- 1186-095052-750-SDFA-20D

Options:

- SDF = Tool makes a "+" pattern
- SDFA = Tool makes a "x" pattern
- 20D = 20° Cone Angle (30° standard)
- Bottlenecks may be designed

Lengths:

- 375 = 0.375 in./9.52mm
- 437 = 0.437 in./11.1mm
- 625 = 0.625 in./15.88mm
- 750 = 0.750 in./19.05mm
- 828 = 0.828 in./21.03mm
- 1.0 = 1.000 in./25.4mm
- Other = Specify

DASH NUMBER	T 30° in./μm ±.0003/8	PVH in./μm ±.0001/3	PVR in./μm ±.0001/3
020020	.0020/51	.0002/5	.0000/0
032030	.0032/81	.0003/8	.0000/0
050030	.0050/127	.0003/8	.0000/0
050032	.0050/127	.0003/8	.0002/5
050052	.0050/127	.0005/13	.0002/5
060052	.0060/152	.0005/13	.0002/5
075052	.0075/191	.0005/13	.0002/5
095052	.0095/241	.0005/13	.0002/5
095104	.0095/241	.0010/25	.0004/10
120104	.0120/305	.0010/25	.0004/10
150104	.0150/381	.0010/25	.0004/10