

Ø0.0624  
 +.0001  
 -.0002  
 Ø1.585mm  
 +.003mm  
 -.005mm

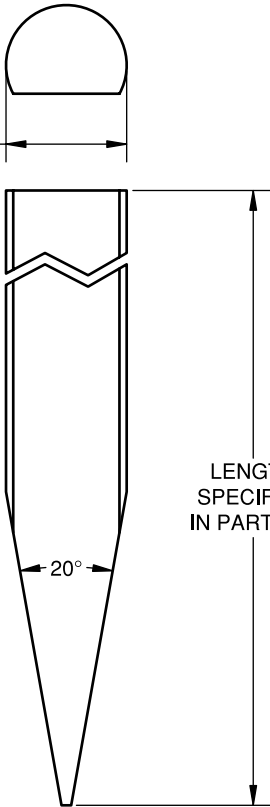

0.0460  
 ±.0005  
 1.168mm  
 ±.013mm

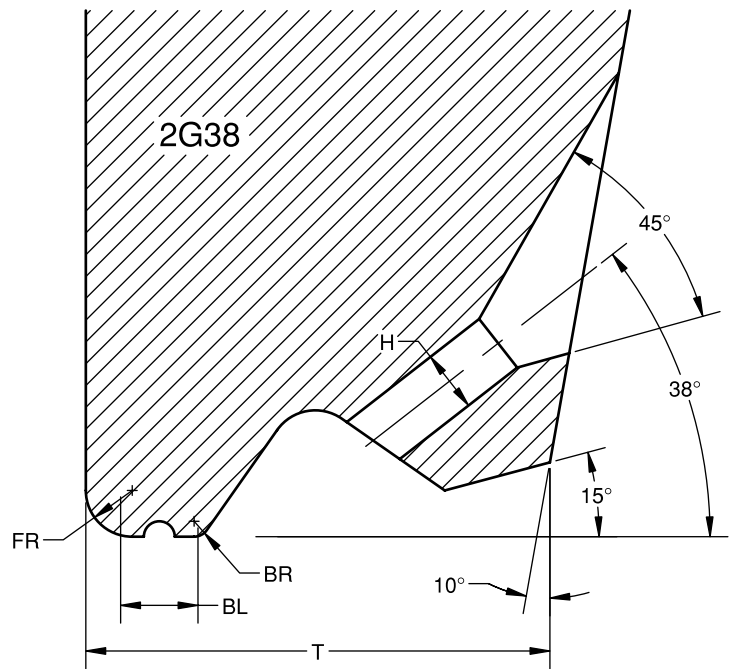
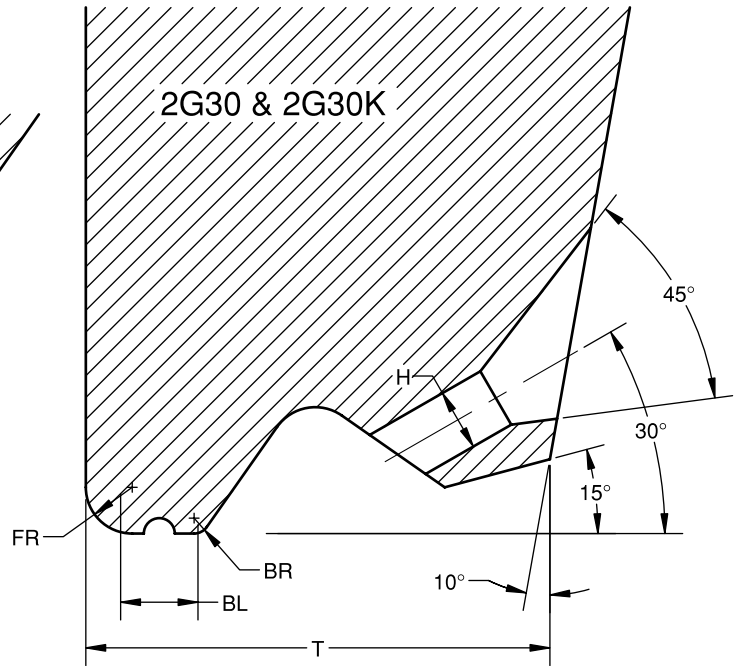
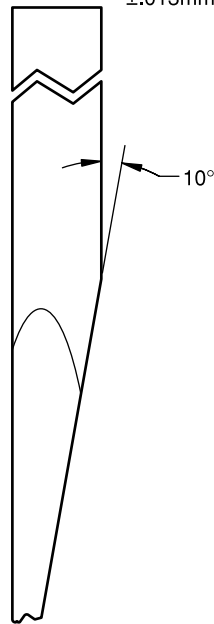

**Specify:**

Series/Wire Feed Angle - Hole Size/Bond Length - Length - Options

**Example:**

2G30-2020-S

2G30K-1510-3/4-TiC

**Material:**

Tungsten Carbide Standard

Titanium Carbide Optional

(Specify "TiC" in part no.)

Cermet Tip Optional

(Specify "BK CER" in part no.)

SERIES: 2G30 & 2G38							
DASH NUMBER	H in./ $\mu$ m $\pm$ .0002/5	BL in./ $\mu$ m $\pm$ .0002/5	W in./ $\mu$ m $\pm$ .0002/5	FR in./ $\mu$ m $\pm$ .0002/5	BR in./ $\mu$ m $\pm$ .0002/5	T 30° & 38° in./ $\mu$ m $\pm$ .0005/13	SUGGESTED WIRE DIAMETER in./ $\mu$ m
1515	.0015/38	.0015/38	.0040/102	.0010/25	.0005/13	.0110/279	.0007/18 to .0008/20
1815	.0018/46	.0015/38	.0050/127	.0015/38	.0005/13	.0140/356	.0008/20 to .0010/25
1820	.0018/46	.0020/51	.0050/127	.0015/38	.0005/13	.0150/381	
1825	.0018/46	.0025/64	.0050/127	.0015/38	.0005/13	.0150/381	
1830	.0018/46	.0030/76	.0050/127	.0015/38	.0005/13	.0160/406	
2015	.0020/51	.0015/38	.0050/127	.0015/38	.0005/13	.0140/356	.0010/25
2020	.0020/51	.0020/51	.0050/127	.0015/38	.0005/13	.0150/381	
2025	.0020/51	.0025/64	.0050/127	.0015/38	.0005/13	.0150/381	
2030	.0020/51	.0030/76	.0050/127	.0015/38	.0005/13	.0160/406	
2040	.0020/51	.0040/102	.0050/127	.0015/38	.0005/13	.0170/432	.0010/25 to .0013/33
2520	.0025/64	.0020/51	.0050/127	.0015/38	.0005/13	.0170/432	
2525	.0025/64	.0025/64	.0050/127	.0015/38	.0005/13	.0170/432	
2530	.0025/64	.0030/76	.0050/127	.0015/38	.0005/13	.0180/457	
2535	.0025/64	.0035/89	.0050/127	.0015/38	.0005/13	.0180/457	.0015/38 to .0018/46
2540	.0025/64	.0040/102	.0050/127	.0015/38	.0005/13	.0190/483	
3020	.0030/76	.0020/51	.0050/127	.0015/38	.0005/13	.0180/457	
3025	.0030/76	.0025/64	.0050/127	.0015/38	.0005/13	.0190/483	
3030	.0030/76	.0030/76	.0050/127	.0015/38	.0005/13	.0190/483	.0020/51
3035	.0030/76	.0035/89	.0050/127	.0015/38	.0005/13	.0200/508	
3040	.0030/76	.0040/102	.0050/127	.0015/38	.0005/13	.0200/508	
3530	.0035/89	.0030/76	.0060/152	.0015/38	.0005/13	.0220/559	
3535	.0035/89	.0035/89	.0060/152	.0015/38	.0005/13	.0230/584	.0020/51
3540	.0035/89	.0040/102	.0060/152	.0015/38	.0005/13	.0230/584	
3545	.0035/89	.0045/114	.0060/152	.0015/38	.0005/13	.0240/610	
3550	.0035/89	.0050/127	.0060/152	.0015/38	.0005/13	.0240/610	
SERIES: 2G30K							
DASH NUMBER	H in./ $\mu$ m $\pm$ .0002/5	BL in./ $\mu$ m $\pm$ .0002/5	W in./ $\mu$ m $\pm$ .0002/5	FR in./ $\mu$ m $\pm$ .0001/2.5	BR in./ $\mu$ m $\pm$ .0001/2.5	T 30° in./ $\mu$ m $\pm$ .0005/13	SUGGESTED WIRE DIAMETER in./ $\mu$ m
2015	.0020/51	.0015/38	.0040/102	.0003/8	.0002/5	.0150/381	.0010/25
2020	.0020/51	.0020/51	.0040/102	.0003/8	.0002/5	.0150/381	
2520	.0025/64	.0020/51	.0050/127	.0005/13	.0003/8	.0150/381	.0010/25 to .0013/33
2525	.0025/64	.0025/64	.0050/127	.0005/13	.0003/8	.0150/381	
2525B	.0025/64	.0025/64	.0040/102	.0005/13	.0003/8	.0150/381	
2530	.0025/64	.0030/76	.0050/127	.0005/13	.0003/8	.0150/381	
2540	.0025/64	.0040/102	.0050/127	.0005/13	.0003/8	.0180/457	
2560	.0025/64	.0060/152	.0050/127	.0005/13	.0003/8	.0200/508	
DASH NUMBER	H in./ $\mu$ m $\pm$ .0002/5	BL in./ $\mu$ m $\pm$ .0002/5	W in./ $\mu$ m $\pm$ .0002/5	FR in./ $\mu$ m $\pm$ .0002/5	BR in./ $\mu$ m $\pm$ .0001/2.5	T 30° in./ $\mu$ m $\pm$ .0005/13	SUGGESTED WIRE DIAMETER in./ $\mu$ m
3035	.0030/76	.0035/89	.0050/127	.0008/20	.0005/13	.0200/508	.0015/38 to .0018/46
4530	.0045/114	.0030/76	.0100/254	.0010/25	.0006/15	.0260/660	.0030/76
4535	.0045/114	.0035/89	.0100/254	.0010/25	.0006/15	.0260/660	

Other part numbers are available  
 Dimensions in inches unless otherwise specified